

XSStick®W21

Quick Start Guide

1

Insert your microSD- and your SIM Card

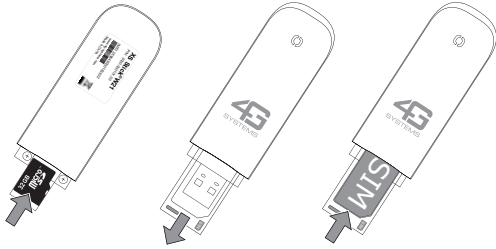

1. Insert the microSD card,
2. Pull out the SIM card tray
3. Insert the SIM card and Push in the SIM card tray *
4. To remove the cards proceed similarly.

* SIM card tray must be pushed in completely in the equipment!

3

The XSManager

The **XSManager** is ready after the installation has been completed successfully.

You can use it to control all functions of the **XSStick®W21**. Starts it by double clicking the icon in the programs list. When requested, enter the PIN of your SIM card and confirm with OK.

Function of the XSManager

These features can be started by pressing one of the following buttons:

Connect:	Connect to the Internet.
SMS:	Send or read short messages.
Statistics:	View details of the current connection.
Web:	Opens your default web browser.
Settings:	Opens a dialog to configure your XSStick®W21 .

5

Safety information

To protect yourself and the device from damage, please observe the following when using and handling the **XSStick®W21**:

The **XSStick®W21** is designed solely for use in dry heated rooms.

It must be kept away from fire and flames!

Do not use the **XSStick®W21** in areas with potentially explosive atmospheres.

Prevent the device from exposure to direct sunlight or heat.

The device must not come into contact with liquid as this could result in electric shock, short-circuiting or total destruction of the device or worse.

Do not open the housing of the **XSStick®W21**. This could cause a hazard to the user or damage the device.

With abusive and inappropriate treatment, use of force and with interferences, which were not made by our authorized service address, expires the warranty claim.

2

Windows™ 8, 7, Vista & XP

On connecting the **XSStick®W21** to the computer, you will find the **XSStick®W21** as a drive under „My Computer“.

Open this drive using e.g. Windows Explorer and start the application "XSManagerinstallation.exe". Then follow the instructions of the installation wizard.

MAC OS X™ 10.5 or higher

A window with the disk image XSManager.dmg will open automatically after connecting the **XSStick®W21** to the computer.

A virtual drive is opened by double-clicking this file. Double-click the **XSManager** symbol to start the installation. Then follow the instructions of the installation wizard.

4

Free Memory of your XSStick®W21

The **XSStick®W21** comprises a microSD card slot and it supports microSD cards of up to 32 GB.

This option gives you the freedom of flexible, mobile data storage, all in one device.

Please use the standard function of your operating system to format a storage device for initial setup. This has to be done only once.

Afterwards the memory of your **XSStick®W21** can be accessed like an usual USB flash drive.

Disposal information

The European directive which became effective on February 13th 2003 and which was implemented in the Federal Republic of Germany on August 18th 2005 for the prevention of electronic and electrical waste has led to a considerable change in the handling of electrical devices at the end of their useful lives. The fundamental reason for this directive is the prevention of electronic and electrical waste. This includes waste management strategies that focus on reuse, recycling, reconditioning or other forms of recycling of such waste to reduce waste materials. 

The use of the symbol () indicates that this product may not be treated as household waste. You are responsible for disposing of all your electrical and electronic waste correctly in the appropriate disposal service e.g. recycling ground. By ensuring this product is disposed of correctly, you will help prevent potential negative consequences for the natural resources, environment and human health which could otherwise be caused by inappropriate waste handling of this product. For more detailed information about recycling of electronic and electrical waste, please contact your local city office, your household waste disposal service, the shop where you purchased the product or the product manufacturer.